

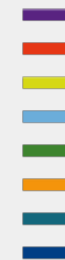

Kiel University





# BASIC FACTS



KIEL UNIVERSITY



# OUR BIG CHALLENGE





# KIEL UNIVERSITY INTERFACES FOCUSSING ON INTERFACES

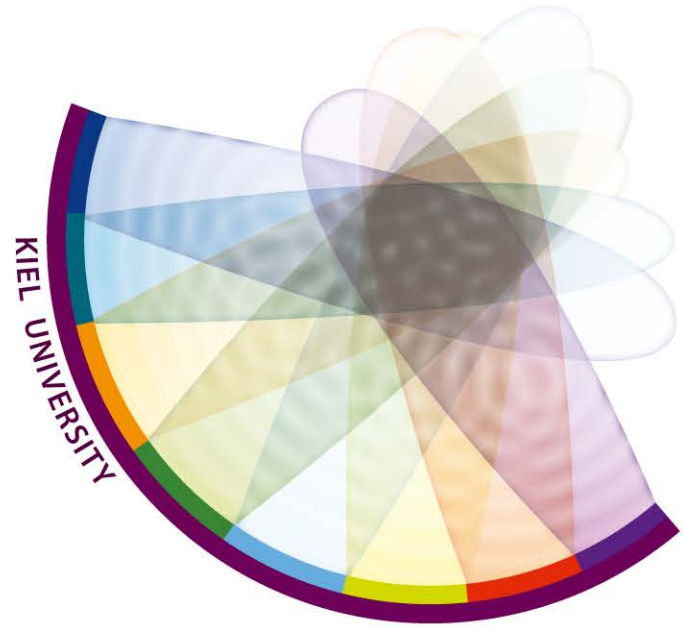

Anlage

## THE KIEL WAY

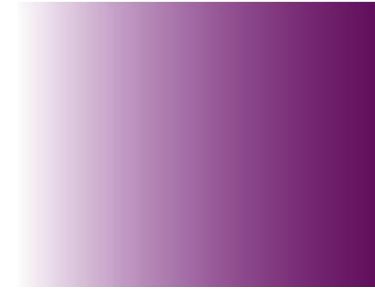

# 4 PRIORITY RESEARCH AREAS

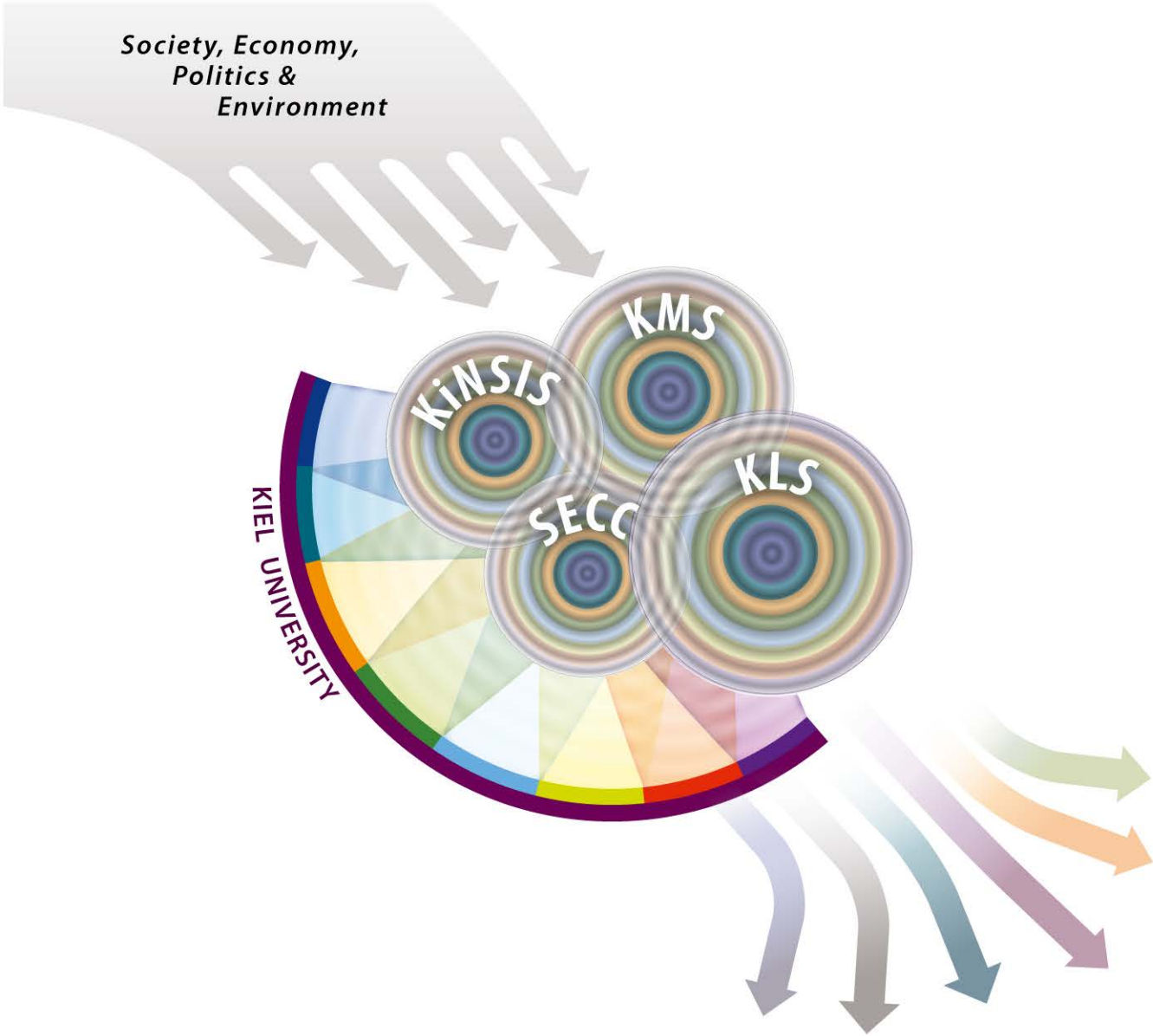

Based on:

- past performance
- innovative potential
- existence of collaborative projects across two or more faculties
- strong regional research partners

With:

- autonomous budgets
- scientific advisory boards



# UNIVERSITY OF INTERCONNECTED RESEARCH CULTURES

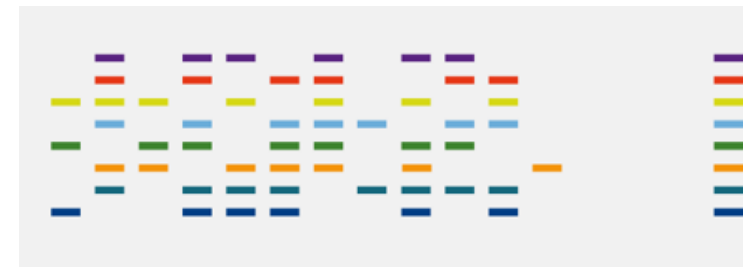
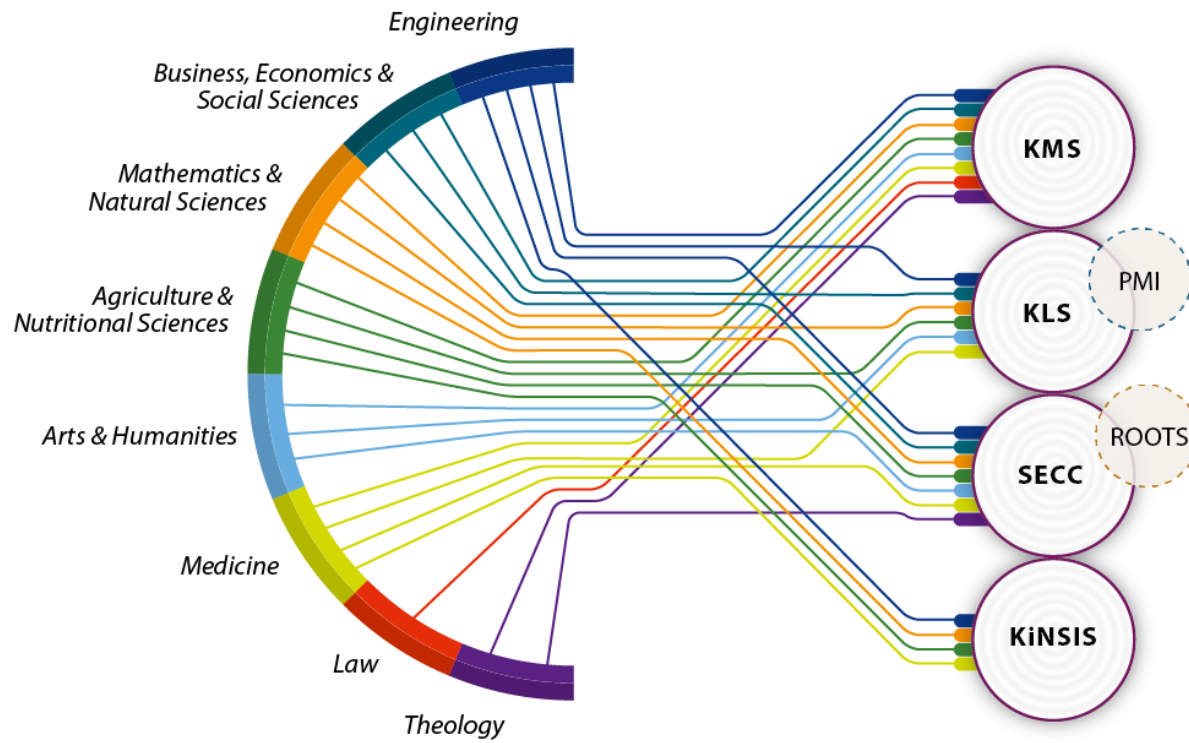



# THE KIEL WAY WORKS!

- **1 €** state funding ➔ **0.56 €** third party funding
- third party funding **doubled** in last decade
- **8 interdisciplinary CRCs** (6 in lead)
- **3 Leibniz ScienceCampi**
- **7 ERC grants**

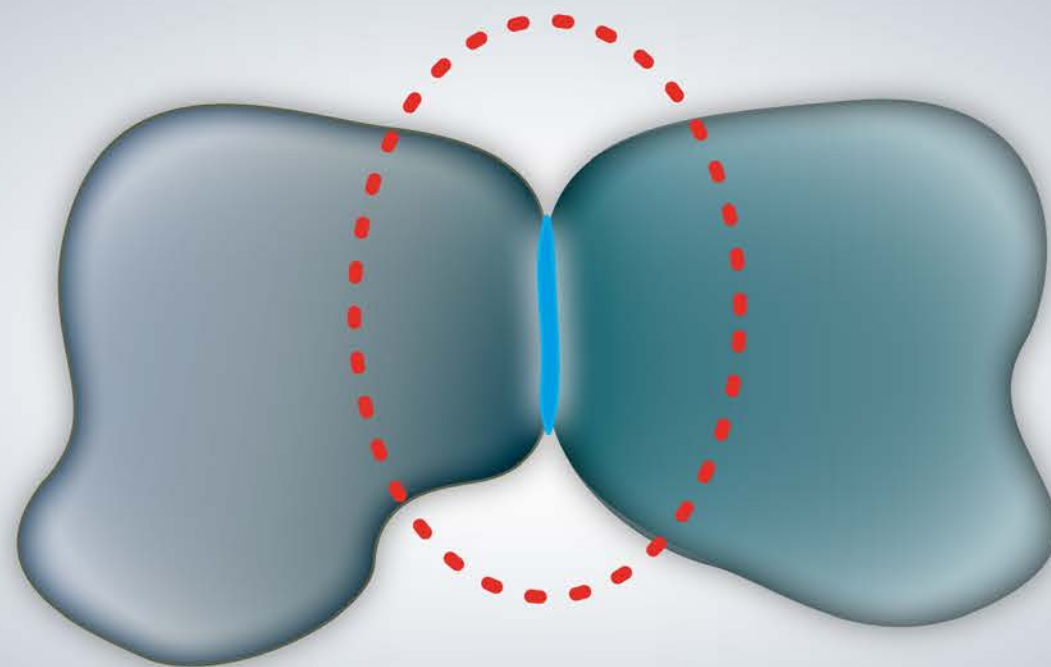





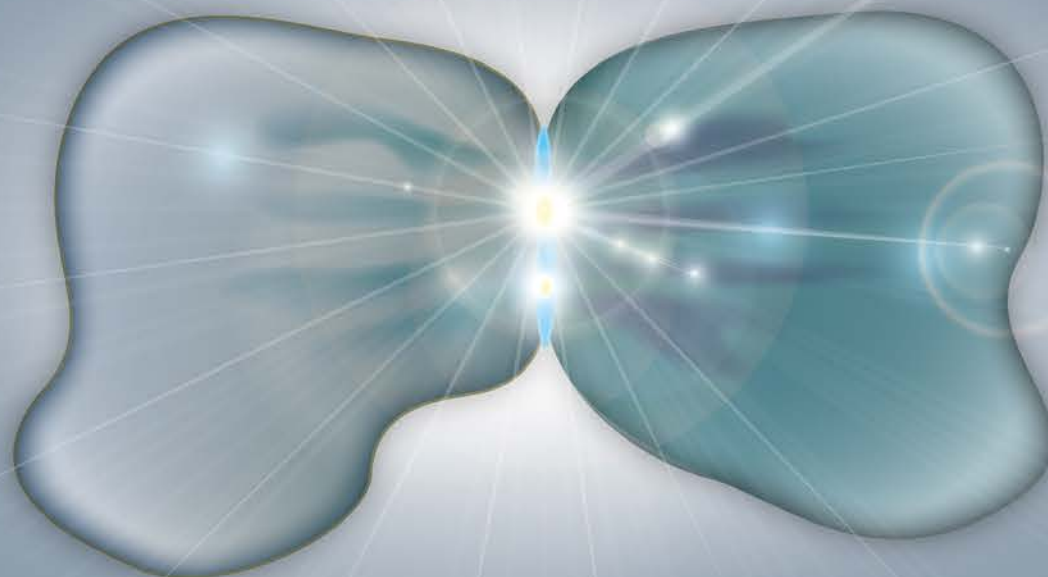

... two or more **systems** get in touch & there is exchange across the boundary



*Kiel Marine Science*  
human-ocean

*Kiel Life Science*  
systems/organs-environment

*KINSIS*  
materials-brain

*SECC*  
past-present

**2000:**  
Strong disciplines  
fundamental

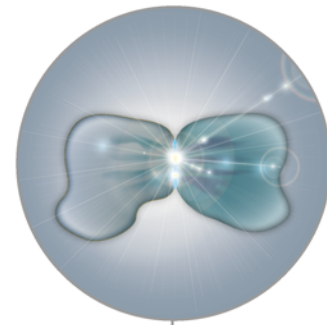

*shaping  
interfaces*

**Today:**  
interconnected  
research cultures

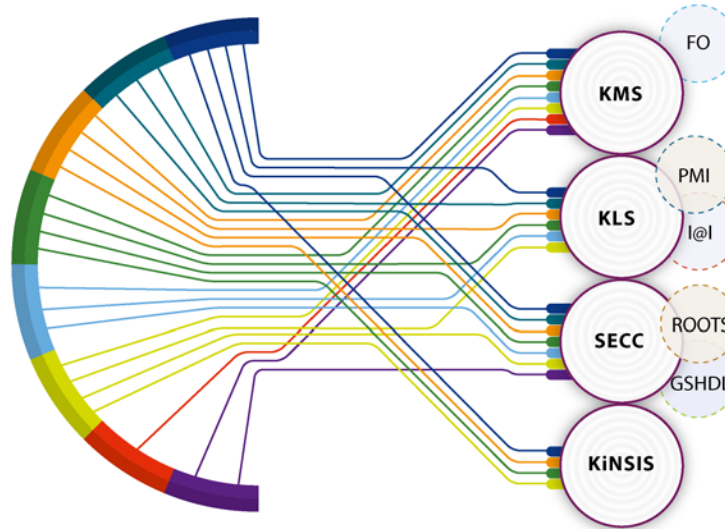

**Tomorrow:**  
strengthen interfaces  
to “outside world”

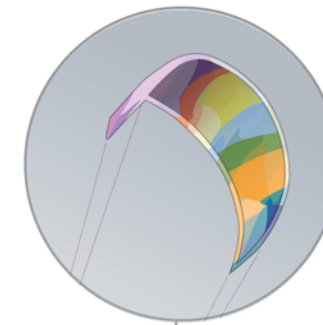

*shape & navigate  
interfaces*





Anlage



# PARTICIPATION PROCESS

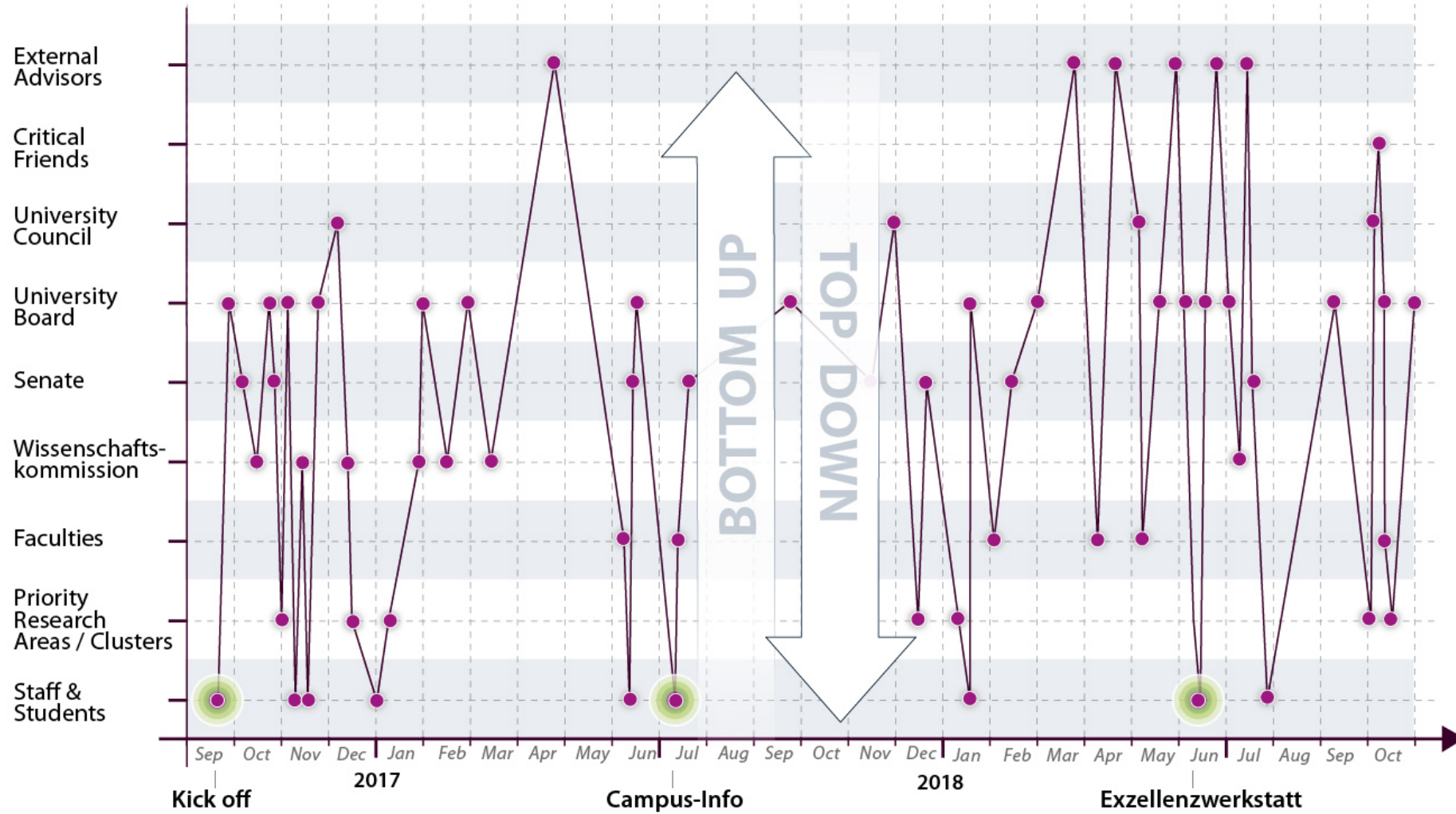

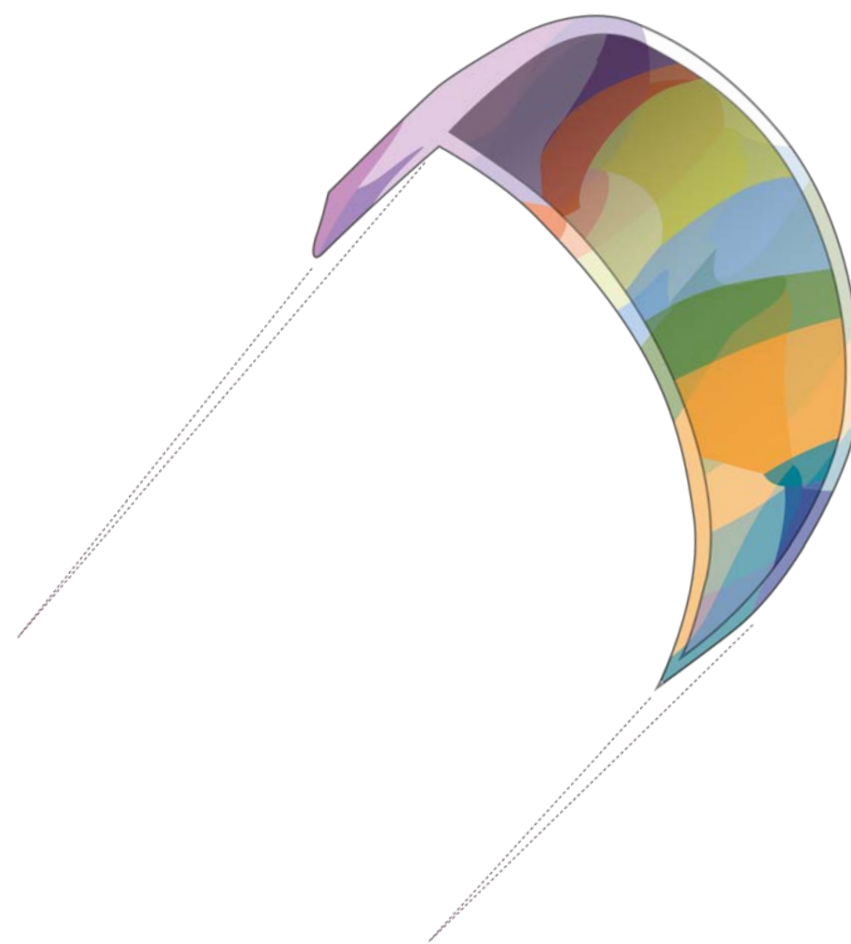

Research  
Learning  
Exchange  
Enable (cross-cutting category)



# KITE | KIEL INTER- AND TRANSDISCIPLINARY EXPLORATION

...

:



Anlage



# LOCAL INTERFACES | SPACES AND FORMATS FOR INTERACTION

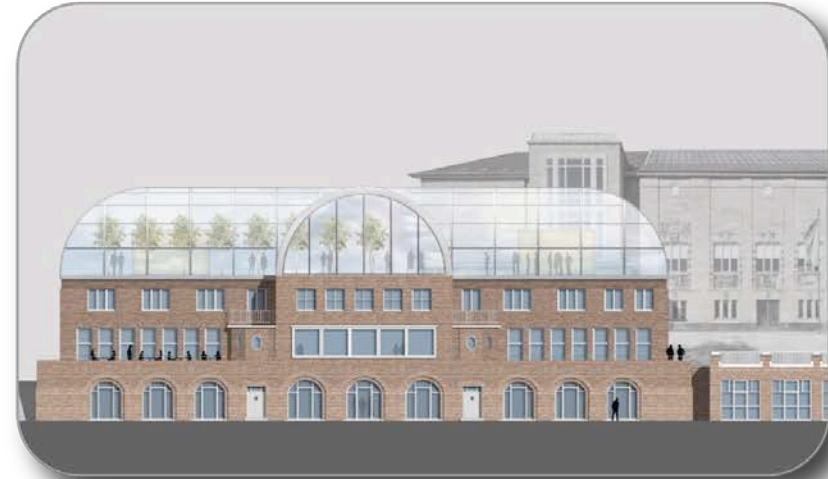

Public Campus: Seeburg 2.0



Inter Spaces



Kiel Science Factory



# REGIONAL INTERFACES

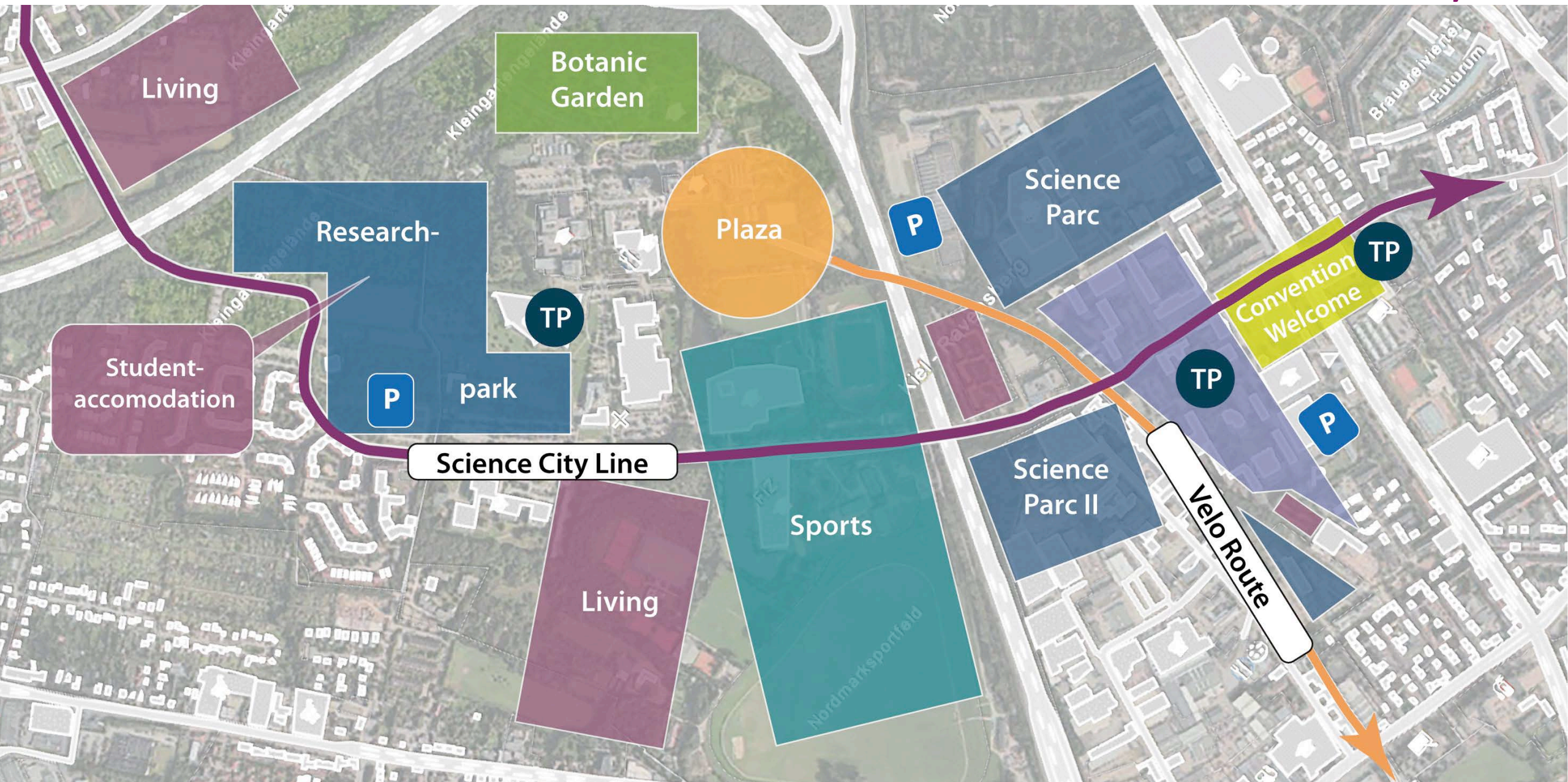



# REGIONAL INTERFACES

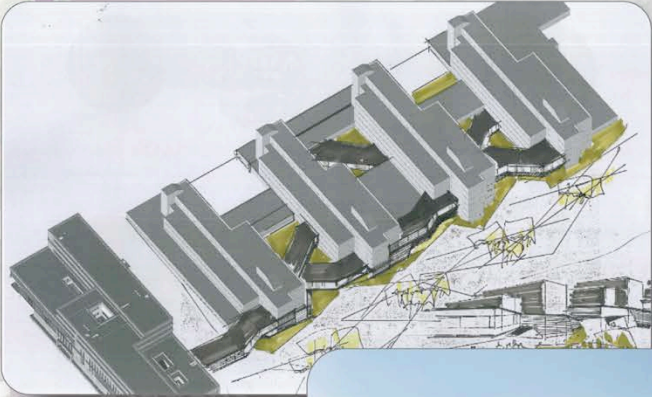

Botanic Garden

TP



Science Parc



accomodation

Living



Weiden



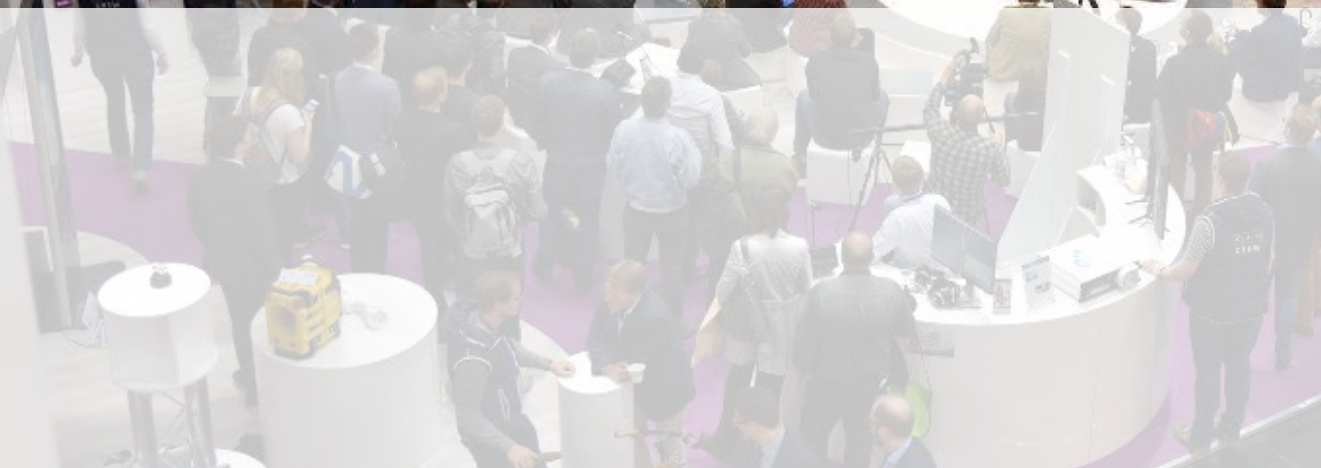



# INTERNATIONAL INTERFACES | OUR STRATEGIC PARTNERSHIPS

**Bay Area**  
**Sister City: San Francisco**

**Scandinavia / Baltic Region**  
**Sister City: Aarhus**

**SH Sister Province: Zhejiang**  
**Sister University: Zhejiang**

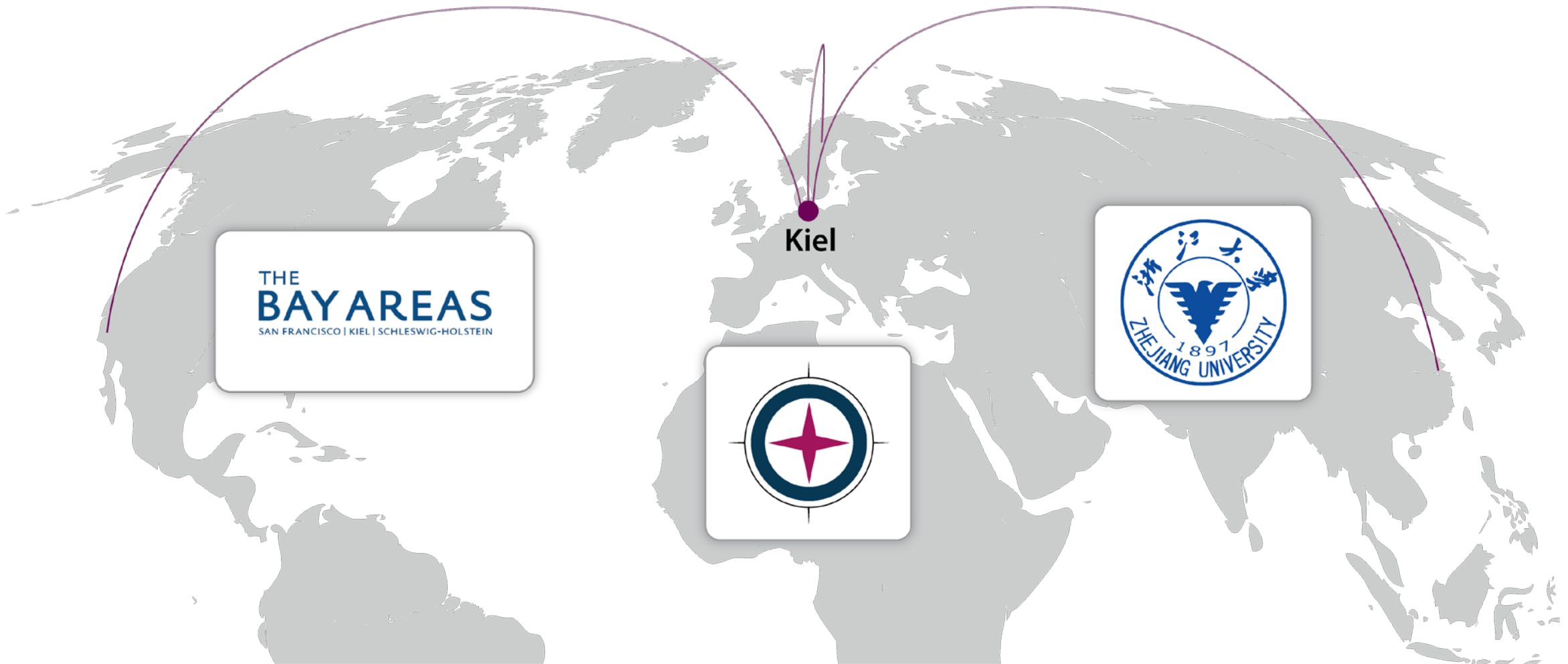



# KITE | KIEL INTER- AND TRANSDISCIPLINARY EXPLORATION

...

:



Anlage



# SCIENCE LED GOVERNANCE | COMMITTEE ON RESEARCH

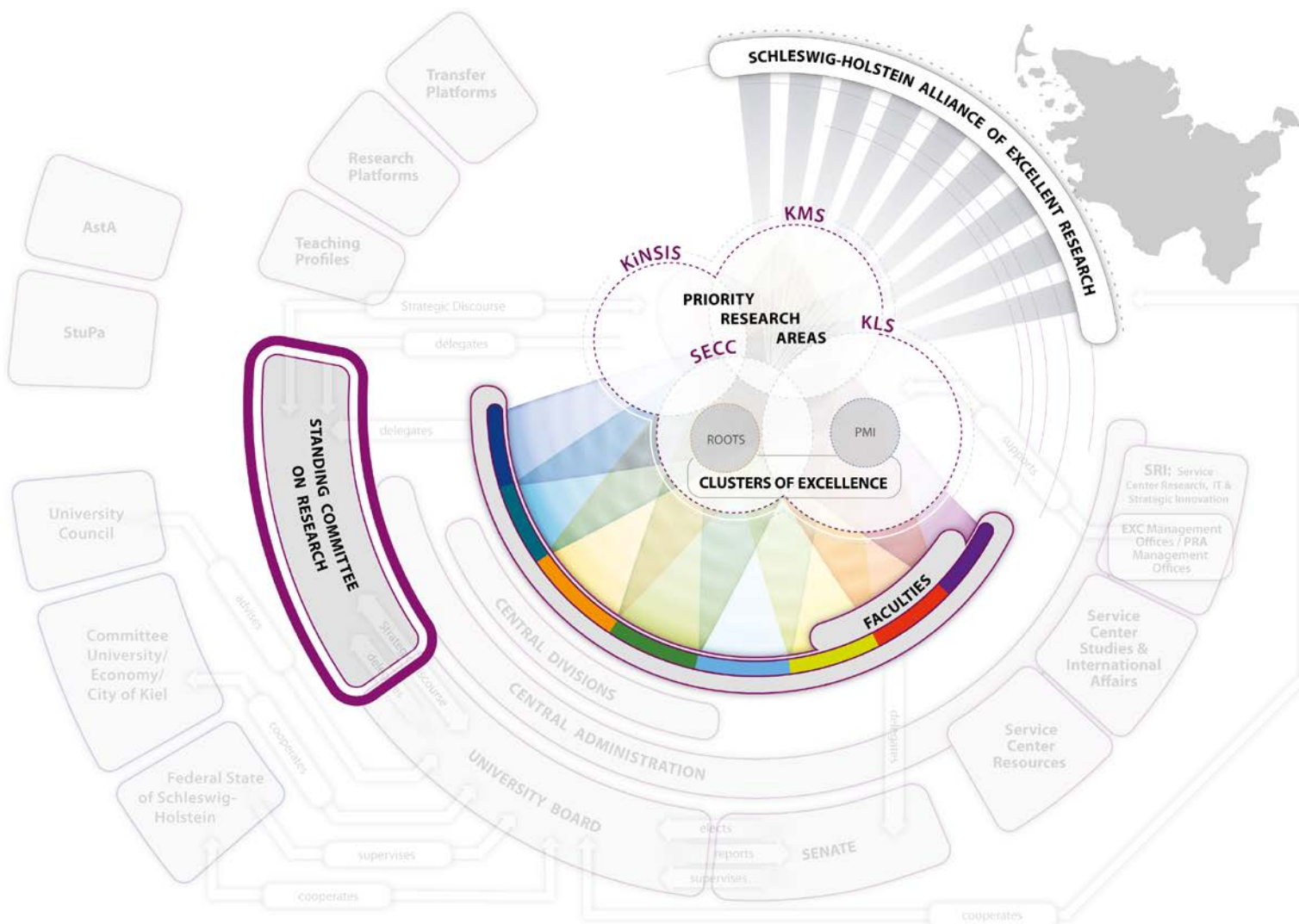

creating and shaping the interface:  
**KITE** measures...

- **empowering people to communicate**

Anlage





## Continuing Professional Development



## Teaching



## Science Factory





# DRIVING FORCE IN CENTER OF SOCIETY

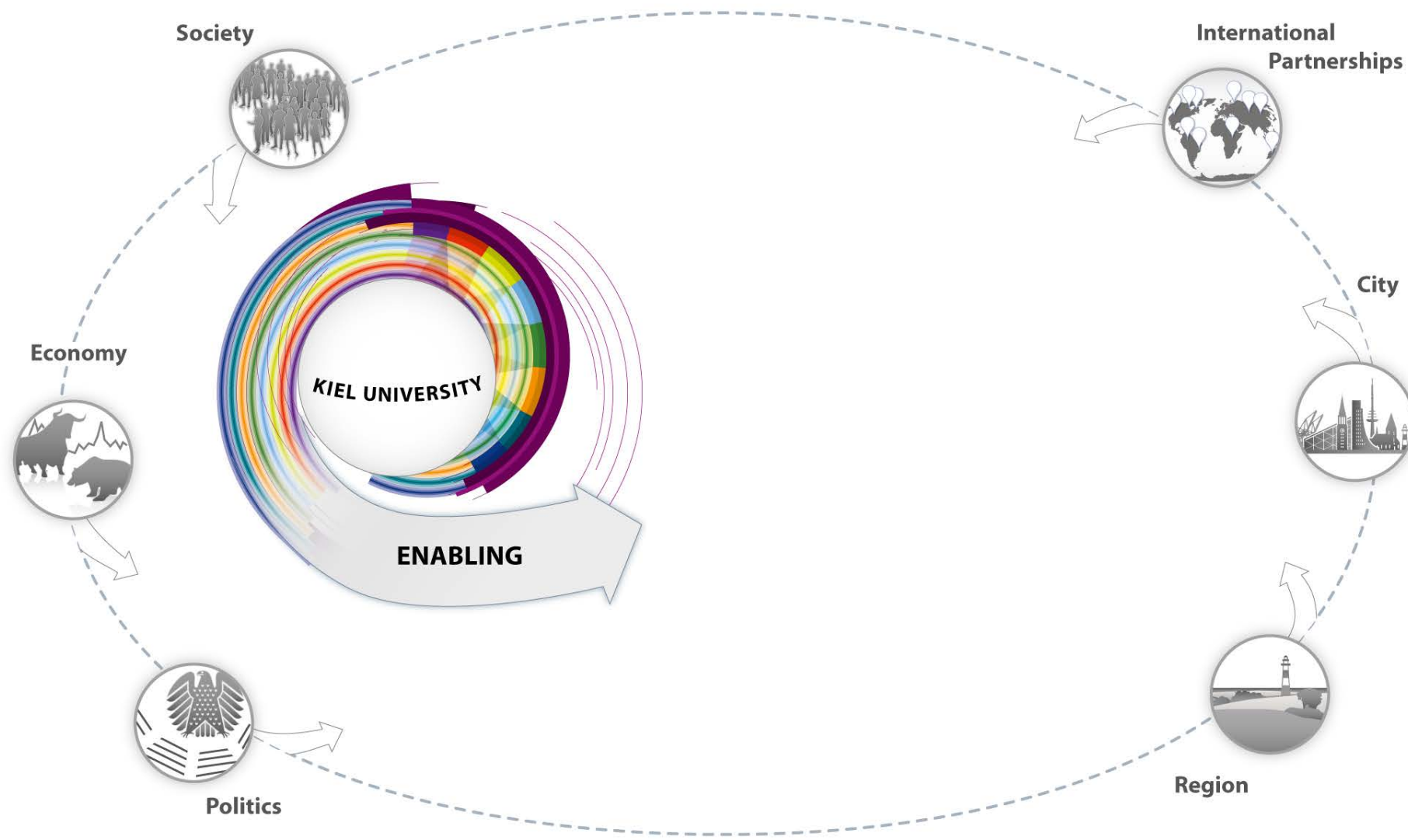

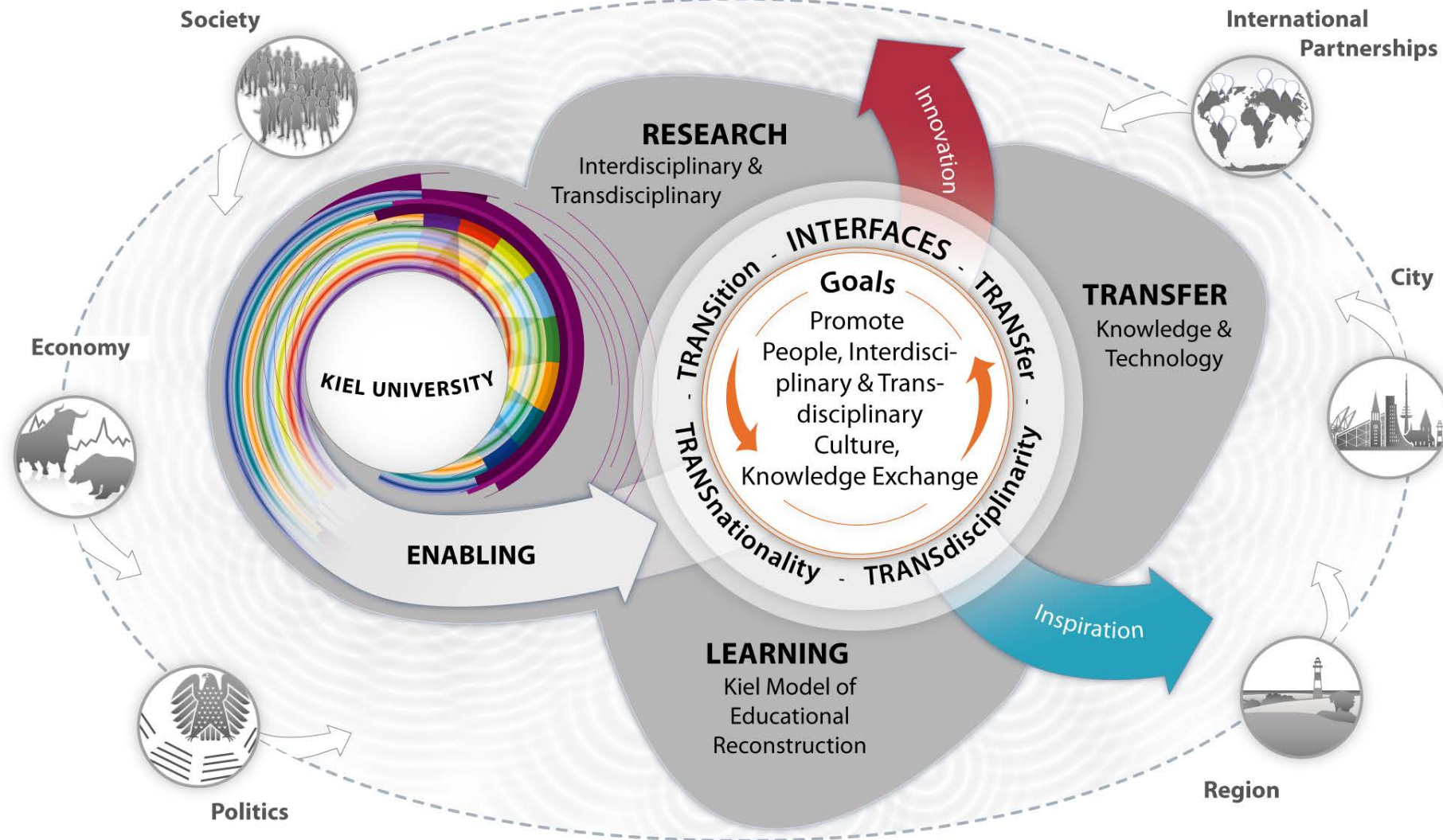



## Reflexion

Anlage



**2000:**  
Strong disciplines  
fundamental

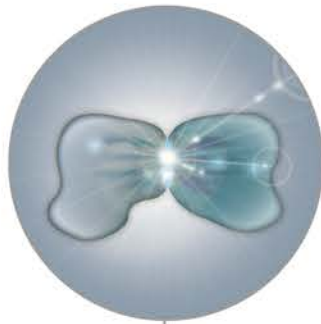

**Today:**  
interconnected  
research cultures

**Tomorrow:**  
strengthen interfaces  
to "outside world"

**2026:**  
the INTERFACE  
UNIVERSITY



*shaping  
interfaces*

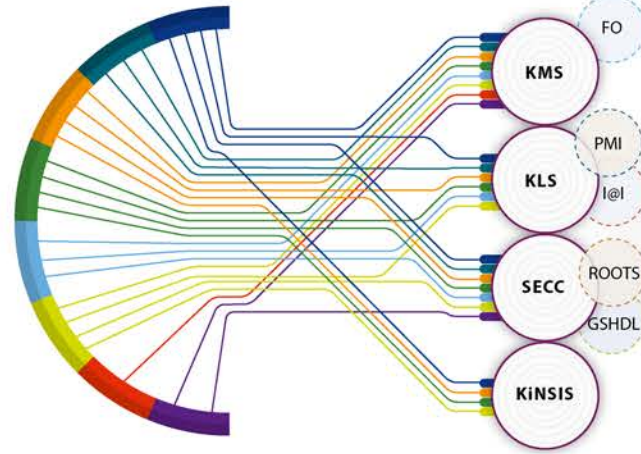

*shape  
& navigate  
interfaces*

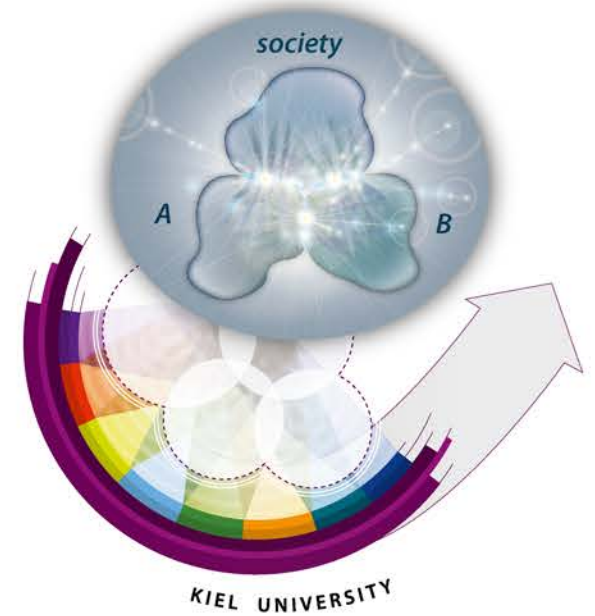





## Entscheidung der Exzellenzkommission vom 27. September 2018

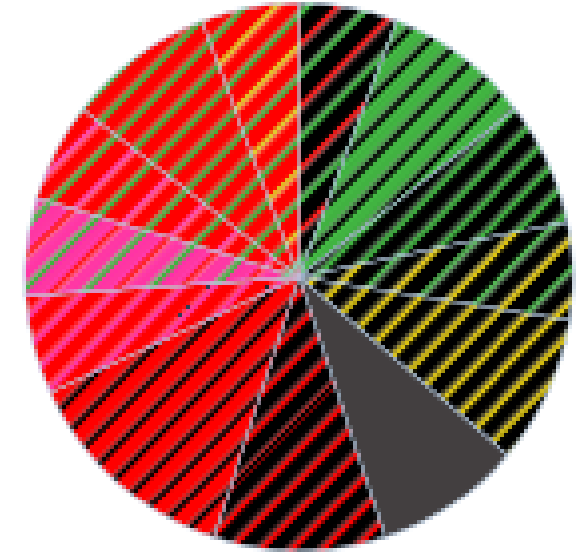
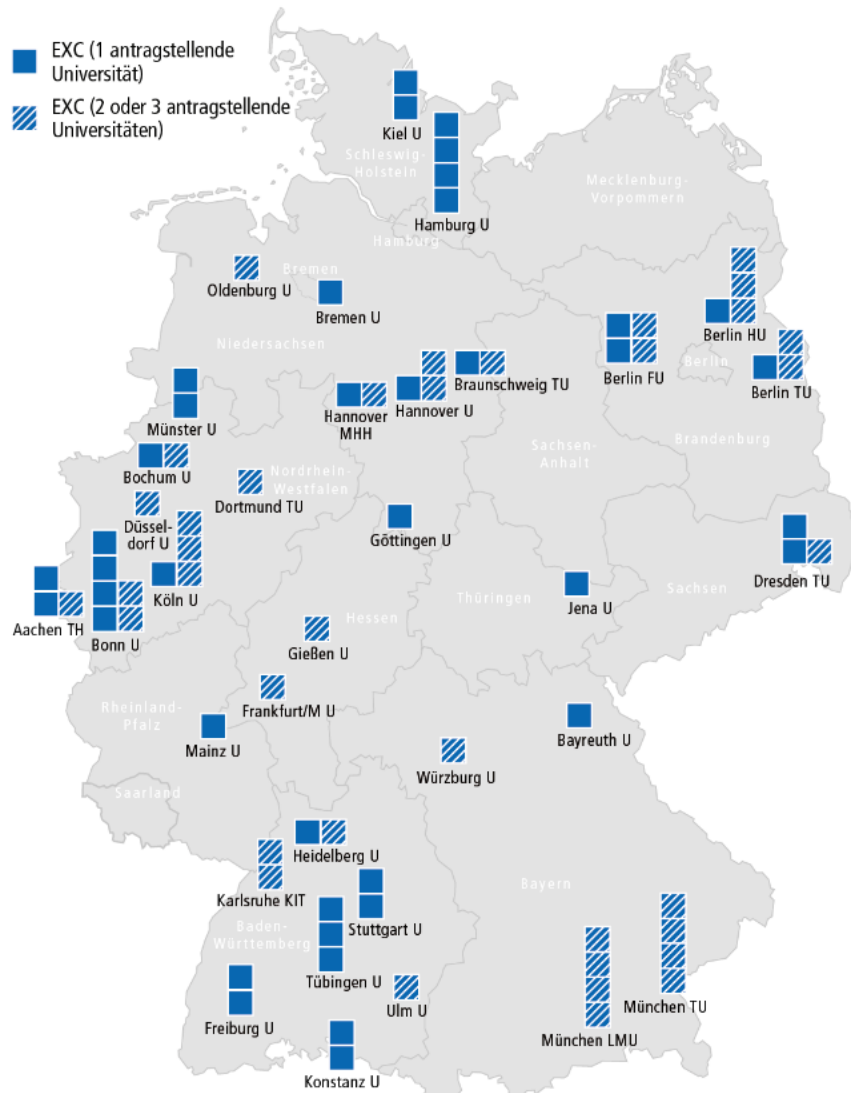

	CDU + GRÜNE	5
	SPD + CDU	9
	SPD + FDP + GRÜNE	4
	CDU + SPD	7
	GRÜNE + CDU	6
	CDU + SPD + GRÜNE	4
	SPD + LINKE	4
	SPD + LINKE + GRÜNE	4
	CSU	6
	CDU + FDP	6
	LINKE + SPD + GRÜNE	4
	SPD + GRÜNE	6
	CDU + GRÜNE + FDP	4





**17** Universitäten und **2** Universitätsverbände sind antragsberechtigt,  
**11** Universitäten bzw. Verbände werden ausgewählt



Exzellenzuniversitäten  
2012-2019  
(Bremen ist nicht länger  
antragsberechtigt)

Exzellenzcluster: 46 → **57**

EXU antragsberechtigt (mindestens 2 Cluster): 14 → **19**

Förderanzahl EXU: **11** (oder weniger)

Entscheidungsprozess (19. Juli 2019):

**1. Expertengremium** (39 Wissenschaftler\_innen) einfache Mehrheit

**+**

**2. Bundesministerin** "Ja"

**+**

**3. Ländervertreter\_innen** (16): einfache Mehrheit → 9 Länder